

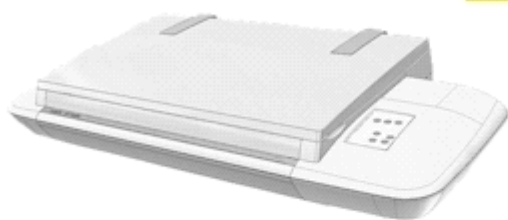

## Technical Overview



## Wide Format Scanners - Product Line 2006

Web: <http://www.vidar.com/wideformat>

April 2006



# Table of Contents

<b>1. Introducing the Vidar Wide Format Scanner Line</b>	<b>1-1</b>
1.1 Scanner Line Model Table	1-1
1.2 What's new?	1-1
1.3 The Scanner Product Line 2006 April	1-2
<b>2. The Copy Scanners</b>	<b>2-1</b>
2.1 About the Titan H36 and Designer 18 Scanners	2-1
2.2 iJET Technology and iJET Panel	2-1
2.3 Connection and Configuration Solutions	2-2
<b>3. Key Features - Fulfilling User Needs</b>	<b>3-1</b>
3.1 General Product Features	3-1
3.1.1 Upgradeable through the Smart Card	3-1
3.1.2 Easy installation – The WIDEsystem Tools CD	3-1
3.1.3 Interfaces – FireWire, USB, SCSI and LAN	3-1
3.1.4 Operating Systems	3-2
3.1.5 STI (Still Image Interface)	3-3
3.1.6 WIA (Windows Image Acquisition)	3-3
3.1.7 TWAIN	3-4
3.2 Features for High Scanning Quality	3-4
3.2.1 Sensors	3-4
3.2.2 Scan modes	3-4
3.2.3 Digital Image Processing	3-4
3.2.4 Accuracy Lens Enhancement Technology (ALE)	3-5
3.3 Maintenance Tools for Continuous Problem-free Scanning	3-6
3.3.1 The importance of Scanner Maintenance	3-6
3.3.2 Fully Automatic Camera Alignment – Built into the Scanner	3-6
3.3.3 Fully Automatic Camera Calibration	3-6
3.3.4 Auto Monitoring and Correction	3-6
3.3.5 Fast and Easy Replacement of Vital Scanner parts	3-6
3.3.6 Scanner Validation	3-7
3.3.7 Advanced Diagnostics Reporting	3-7
3.4 Special User Features	3-8
3.4.1 Advanced Power Management	3-8
3.4.2 ENERGY STAR®	3-8
3.4.3 One Touch Scanning – Scan, Copy, E-mail	3-8
3.4.4 Document feeding mechanism - Care for your original	3-9
3.4.5 Thick originals	3-9
3.4.6 Versatile scanner through software support	3-9
3.4.7 RoHS and WEEE Compliancy - Scanners for a Better Environment	3-10
<b>4. Specification Comparison Table – WIDE Format Scanners</b>	<b>4-1</b>

## 1. Introducing the Vidar Wide Format Scanner Line

### 1.1 Scanner Line Model Table

Below are the models that make up the current scanner line. This technical overview covers the models listed.

Scanner Model	Model ID	Scanner Type
Atlas P54 BASE, PLUS	GH67D	4 Camera 54" Wide Format, Color & Monochrome
Atlas H42 BASE, PLUS 	GS67D	3 Camera 42" Wide Format, Color & Monochrome
Select H42 BASE, PLUS 	GT67D	3 Camera 42" Wide Format, Color & Monochrome
Atlas P36 BASE, PLUS	GK679	2 Camera 36" Wide Format, Color & Monochrome
Select P36 BASE, PLUS	GL67D	2 Camera 36" Wide Format, Color & Monochrome
Select MP36 BASE, PLUS	GM67D	2 Camera 36" Wide Format, Monochrome
Nova MP36 BASE, PLUS	HB68A	1 Camera 36" Wide Format, Color & Monochrome
Nova XP36 BASE, PLUS	HA68A	1 Camera 36" Wide Format, Color & Monochrome
Designer 18	AA51A	1 Camera, A2 Flatbed, 18" Wide Format <b>Copy</b> , Color & Monochrome
Titan H36 BASE, PLUS	KA67E	3 Camera, 36" Wide Format <b>Copy</b> , Color & Monochrome
Atlas SP25 BASE, PLUS	GQ67D	1 Camera 25" Wide Format, Color & Monochrome
Select SP25 BASE, PLUS	GR67D	1 Camera 25" Wide Format, Color & Monochrome

### 1.2 What's new?

Vidar maintains its leading position in the wide-format scanner market through continued product development, which is instrumental in maintaining a technological edge in all Vidar scanners and software. A strong emphasis on continued research and development ensures Vidar clients of state-of-the-art capabilities.

Here are some of this fall's technological highlights:

- Introducing two new scanners to the high speed (H) line to replace the two current 42-inch models. The Atlas H42 and Select H42 are high speed scanners with all the latest high end features such as user replaceable parts, ATAC (Auto Thickness Adjustment Control) and a max resolution of 9600 dpi.
- The new scanner line is about speed. The H PLUS scanner models scan monochrome at 12 inch/sec which is 4 to 6 inches per second faster compared to their previous counterpart models.
- Yet another quality feature is a high optical resolution of **508 dpi** on the new H models. The high end Titan H36 scanner, introduced last summer, still retains the highest optical resolution of the Contex scanner line with 600 dpi.
- ENERGY STAR<sup>®</sup> - Our latest 42-inch H scanners, Atlas H42 and Select H42 support automatic power down with power values that meet **ENERGY STAR<sup>®</sup>** criteria, an important brand selection factor for many customers in many parts of the world. The power down timer can be set in WIDESystem as actual clock values or as an idle time period (ENERGY STAR requirement).



- RoHS and WEEE Compliancy – The new 42-inch H scanners meet the strictest directives for a better environment. The RoHS and WEEE European Market directives define maximum levels for certain substances in products containing electronic components and set rules that help minimize problems caused by electrical waste materials.

## 1.3 The Scanner Product Line 2006 April

### Titan H36 BASE and Titan H36 PLUS Copy Color Scanners

With integrated copy/scan processing called “**iJET Technology**”, the Titan HS 36 marks a new era for scan to print solutions. The new **iJET Panel** opens an elaborate menu system that enables setup and activation of full scan-to-print and scan-to-file options directly from the scanner without the need for control through a PC and software. All processing is performed inside the scanner. Activation of Scan-to-print will send the image directly to a local or network printer and with scan-to-file you can save the image data to any local or network PC that is setup to be recognized by the scanner.



**Direct Printer Interfacing:** The scanner supports both LAN and USB printer connection options so large format printers can be hooked up and used for copy output directly from the scanner with control through the scanner’s iJET panel. The scanner and connected printer thus form an easy to use and “best of breed” **large format copier** at prices competitive with the market’s current all-in-one copy machine solutions.

**Direct LAN interfacing:** With the scanner’s LAN interface, users can connect the scanner to the local network enabling a company’s employees to share the scanner and use it with other LAN connected devices such as printers and remote PC stations.

The TITAN H36 is among our fastest scanners and with an optical resolution of 600 dpi it supports the best in image quality and high-end features.

***Read more about the new copy functionality and LAN interfacing in the next section.***

**Includes:** iJET Panel, LAN interfacing, dedicated USB printer interface and Hi-Speed USB PC interface, user replaceable parts.

	Titan H36 BASE	Titan H36 PLUS
<b>Scan Width</b>	36"	36"
<b>Optical Resolution</b>	600 dpi	600 dpi
<b>Max Resolution</b>	1200 dpi	9600 dpi
<b>Color Speed at 400 dpi turbo</b>	1.5 "/sec	3.0 "/sec
<b>Index Speed at 400 dpi turbo</b>	3.0 "/sec	3.0 "/sec
<b>Graytone and B/W Speed at 400 dpi turbo</b>	6.0 "/sec	12.0 "/sec
<b>Scan Accuracy</b>	0.1% +- 1pixel	0.1% +-1 pixel
<b>Interface</b>	LAN + Hi-Speed USB	LAN + Hi-Speed USB

## Designer 18 – A2 Flatbed Copy Color Scanners

We proudly introduce our new A2 flatbed scanner, designed for ease of use while offering all the high quality scanning technology from the wider sheet feed models. The Designer 18 scanners contain the all-new **iJET Technology** for fully integrated copy/scan processing together with the **iJET Panel**. The panel opens an elaborate menu system for setup and activation of full scan-to-print and scan-to-file options directly from the scanner without the need for control through a PC and software. Activation of Scan-to-print will send the image directly to a local or network printer and with scan-to-file you can save the image data to any local or network PC that is setup to be recognized by the scanner.



**Direct Printer Interfacing:** The scanner supports both LAN and USB printer connection options so large format printers can be hooked up and used for copy output directly from the scanner with control through its iJET panel. The scanner and connected printer thus form an easy to use and “best of breed” **large format copier** at prices competitive with the market’s current all-in-one copy machine solutions.

**Direct LAN interfacing:** With the scanner’s LAN interface, users can connect the scanner to the local network enabling a company’s employees to share the scanner and use it with other LAN connected devices such as printers and remote PC stations.

*Read more about the new copy functionality and LAN interfacing in the next section.*

**Large Format Flatbed:** This is the perfect scanner for users that require an easy to use device for copying or archiving. Users that work with wide formats can finally enjoy the advantages of flatbed loading. This flexible scanner covers special requirements involving scanning/copying of very fragile originals, originals with uneven surfaces, imaging of three-dimensional objects – or just about anything that can be put on the scanner bed. Some of the typical businesses looking for this scanner would be museums, archival institutes, libraries, clipping services photo labs and more.

**Includes:** iJET Panel, LAN interfacing, dedicated full-speed USB host (printer output) interface and Hi-Speed USB device (PC) interface, user replaceable parts.

	DESIGNER 18
Scan Width	18"
Optical Resolution	400 dpi
Max Resolution	9600 dpi
Color Speed at 400 dpi turbo	3.0 "/sec
Index Speed at 400 dpi turbo	3.0 "/sec
Graytone and B/W Speed at 400 dpi turbo	10.0 "/sec
Scan Accuracy	0.1% +-1 pixel
Interface	LAN + Hi-Speed USB

## Atlas P54 BASE and Atlas P54 PLUS Color Scanners

The Atlas P54 wide format color scanners are the widest of our scanner product line and are designed for optimal performance with very large documents in both color and B&W. This is the scanner without limits and the device for businesses that work with different types of large format documents in all sizes and thicknesses. The Atlas P54" scanners are designed with a special All-Wheel-Drive system for a firm grip on very wide originals and a straight scan path.



**Includes:** Automatic Thickness Adjustment Control (ATAC).

	Atlas P54 BASE	Atlas P54 PLUS
Scan Width	54"	54"
Optical Resolution	508 dpi	508 dpi
Max Resolution	800 dpi	9600 dpi
Color Speed at 400 dpi turbo	1.5 "/sec	3.0 "/sec
Index Speed at 400 dpi turbo	3.0 "/sec	3.0 "/sec
Graytone & B/W Speed at 400 dpi turbo	4.0 "/sec	8.0 "/sec
Scan Accuracy	0.1% +- 1pixel	0.1% +-1 pixel
Interface	FireWire + Ultrafast SCSI	FireWire + Ultrafast SCSI

## Atlas H42 BASE and Atlas H42 PLUS Color Scanners



The Atlas H42 wide-format color scanners are designed for high-quality full color scanning and copying of large documents. The PLUS models scan color at an impressive 3.0 "/s at 400 dpi turbo and monochrome at an ultra fast speed of 12"/s at 400 dpi turbo. The scanner's high optical resolution, 42-inch scan width and high speeds make it the perfect device for top quality and reliable high-production scanning for repro, GIS and copy professionals.



**Includes:** Automatic Thickness Adjustment Control (ATAC), user replaceable parts, ENERGY STAR.

	Atlas H42 BASE	Atlas H42 PLUS
Scan Width	42"	42"
Optical Resolution	508 dpi	508 dpi
Max Resolution	800 dpi	9600 dpi
Color Speed at 400 dpi turbo	1.5 "/sec	3.0 "/sec
Index Speed at 400 dpi turbo	3.0 "/sec	3.0 "/sec
Graytone and B/W Speed at 400 dpi turbo	6.0 "/sec	12.0 "/sec
Scan Accuracy	0.1% +- 1pixel	0.1% +-1 pixel
Interface	FireWire + Hi-Speed USB	FireWire + Hi-Speed USB



## Select H42 BASE and Select H42 PLUS Color Scanners.

The Select H42 scanners are designed to give professionals high-speed monochrome scanning with the additional feature of quality color scanning for special jobs. With fast and effective monochrome scanning and the option to scan in perfect color, these devices offer a very cost-effective solution for CAD, AEC and GIS professionals. The PLUS models scan color at 0.6 "/s at 400 dpi turbo and monochrome at an ultra fast speed of 12"/s at 400 dpi turbo. The scanner's high optical resolution, 42-inch scan width and high speeds make it the perfect device for top quality and reliable high-production scanning.



**Includes:** Automatic Thickness Adjustment Control (ATAC), user replaceable parts, ENERGY STAR.

	Select H42 BASE	Select H42 PLUS
<b>Scan Width</b>	42"	42"
<b>Optical Resolution</b>	508 dpi	508 dpi
<b>Max Resolution</b>	800 dpi	9600 dpi
<b>Color Speed at 400 dpi turbo</b>	0.6 "/sec	0.6 "/sec
<b>Index Speed at 400 dpi turbo</b>	3.0 "/sec	3.0 "/sec
<b>Graytone and B/W Speed at 400 dpi turbo</b>	5.0 "/sec	10.0 "/sec
<b>Scan Accuracy</b>	0.1% +- 1pixel	0.1% +-1 pixel
<b>Interface</b>	FireWire + Hi-Speed USB	FireWire + Hi-Speed USB

## Atlas P36 BASE and Atlas P36 PLUS Color Scanners

The Atlas P36 wide format color scanners incorporate the latest in imaging technology for high quality full color scanning and copying. The 36" imaging area handles large color posters, architectural sketches, detailed maps, drawings and fine art of E-size/A0 or smaller. This scanner offers a cost-effective solution for reprographics, graphic arts, GIS and CAD professionals worldwide. The Atlas P36 opens new possibilities for Sign companies, Pre press shops, Pre-press labs, Copy shops, POP/Exhibit/Display providers, Mapping, Architect and Engineer offices.



	Atlas P36 BASE	Atlas P36 PLUS
<b>Scan Width</b>	36"	36"
<b>Optical Resolution</b>	400 dpi	400 dpi
<b>Max Resolution</b>	800 dpi	9600 dpi
<b>Color Speed at 400 dpi turbo</b>	1.5 "/sec	3.0 "/sec
<b>Index Speed at 400 dpi turbo</b>	3.0 "/sec	3.0 "/sec
<b>Graytone and B/W Speed at 400 dpi turbo</b>	3.0 "/sec	6.0 "/sec
<b>Scan Accuracy</b>	0.1% +- 1pixel	0.1% +-1 pixel
<b>Interface</b>	FireWire + Ultrafast SCSI	FireWire + Ultrafast SCSI

## Select P36 BASE and Select P36 PLUS Color Scanners

The Select P36 wide format color scanners, with fast monochrome capabilities, offer top level scanning at a highly affordable price. The 36" imaging area handles large color posters, architectural sketches, detailed maps, drawings and fine art of E-size/A0 or smaller. This scanner offers a cost-effective solution for reprographics, graphic arts, GIS and CAD professionals worldwide and opens new possibilities for even small Sign companies, Pre press shops, Pre-press labs, Copy shops, POP/Exhibit/Display providers, Mapping, Architect and Engineer offices.



	Select P36" BASE	Select P36" PLUS
<b>Scan Width</b>	36"	36"
<b>Optical Resolution</b>	400 dpi	400 dpi
<b>Max Resolution</b>	800 dpi	9600 dpi
<b>Color Speed at 400 dpi turbo</b>	0.3 "/sec	0.3 "/sec
<b>Index Speed at 400 dpi turbo</b>	1.5 "/sec	1.5 "/sec
<b>Graytone B/W Speed at 400 dpi turbo</b>	3.0 "/sec	6.0 "/sec
<b>Scan Accuracy</b>	0.1% +- 1pixel	0.1% +-1 pixel

## Nova XP36 BASE and Nova XP36 PLUS Color Scanners

The Nova XP36 scanner is the result of innovative and revolutionary design solutions making fast high quality scanning affordable for a whole new range of users. This scanner is the perfect solution for CAD and AEC professionals and copy service providers in large and small businesses. The 36" imaging area handles large color posters, architectural sketches, detailed maps, drawings and fine art of E-size/A0 or smaller.



**Includes:** User replaceable parts.

	Nova XP36 BASE	Nova XP36 PLUS
<b>Scan Width</b>	36"	36"
<b>Optical Resolution</b>	200 dpi	200 dpi
<b>Max Resolution</b>	400 dpi	9600 dpi
<b>Color Speed at 400 dpi turbo</b>	0.3 "/sec	3.0 "/sec
<b>Index Speed at 400 dpi turbo</b>	1.5 "/sec	3.0 "/sec
<b>Graytone and B/W Speed at 400 dpi turbo</b>	10.0 "/sec	10.0 "/sec
<b>Scan Accuracy</b>	0.1% +- 1pixel	0.1% +-1 pixel
<b>Interface</b>	FireWire + Hi-Speed USB	FireWire + Hi-Speed USB

## Nova MP36 BASE Monochrome and Nova MP36 PLUS Color Scanners

The Nova MP36 scanner is upgradable from monochrome-only to the Nova MP36 PLUS monochrome and color. These 36" scanners are designed to introduce professionals to monochrome wide format document scanning at a highly affordable price while maintaining the option for color. This is a fast input device, scanning monochrome at 10 "/s at 400 dpi turbo and on the PLUS model also color at 0.3 "/s. The 36" imaging area handles large color posters, architectural sketches, detailed maps, drawings and fine art of E-size/A0 or smaller. This is the perfect cost-effective solution for Sign companies, Pre press shops, Photo labs, copy shops, POP/Exhibit/Display Providers, Architect and Engineer offices.



**Includes:** User replaceable parts.

	Nova MP36 BASE	Nova MP36 PLUS
<b>Scan Width</b>	36"	36"
<b>Optical Resolution</b>	200 dpi	200 dpi
<b>Max Resolution</b>	9600 dpi	9600 dpi
<b>Color Speed at 400 dpi turbo</b>	-	0.3 "/sec
<b>Index Speed at 400 dpi turbo</b>	-	1.5 "/sec
<b>Graytone and B/W Speed at 400 dpi turbo</b>	10.0 "/sec	10.0 "/sec
<b>Scan Accuracy</b>	0.1% +- 1pixel	0.1% +- 1pixel
<b>Interface</b>	FireWire + Hi-Speed USB	FireWire + Hi-Speed USB

## Select MP36 BASE and Select MP36 PLUS Monochrome Scanners

This is a wide format monochrome at a highly affordable price. The Vidar Select MP36 wide-format scanners are designed to give professionals the best in large format monochrome scanning. The 36" wide imaging area handles large E-size/A0 engineering drawings, architectural sketches, maps, blueprints and sepias. The Select MP36 scanners offer top-level image quality at bottom-level prices, making them the perfect cost-effective solution for CAD, AEC and GIS professionals in large and small businesses.



	Select MP36" BASE	Select MP36" PLUS
<b>Scan Width</b>	36"	36"
<b>Optical Resolution</b>	400 dpi	400 dpi
<b>Max Resolution</b>	600 dpi	9600 dpi
<b>Color Speed at 400 dpi turbo</b>	-	-
<b>Index Speed at 400 dpi turbo</b>	-	-
<b>Graytone and B/W Speed at 400 dpi turbo</b>	4.0 "/sec	8.0 "/sec
<b>Scan Accuracy</b>	0.1% +- 1pixel	0.1% +-1 pixel
<b>Interface</b>	FireWire + Ultrafast SCSI	FireWire + Ultrafast SCSI

## Atlas SP25 BASE and Atlas SP25 PLUS Color Scanners

The Atlas SP25 wide format color scanners incorporate the best in wide format imaging technology in a compact 25" scanner. These scanners will fit in any office and are perfect devices for creating in-house graphics and impressive presentations right off the desktop. This scanner is the right investment for Sign companies, Pre press shops, Photo labs, copy shops, POP/Exhibit/Display Providers, Architect and Engineer offices.



	Atlas SP25 BASE	Atlas SP25 PLUS
<b>Scan Width</b>	25"	25"
<b>Optical Resolution</b>	424 dpi	424 dpi
<b>Max Resolution</b>	800 dpi	9600 dpi
<b>Color Speed at 400 dpi turbo</b>	0.5 "/sec	1.5 "/sec
<b>Index Speed at 400 dpi turbo</b>	1.5 "/sec	1.5 "/sec
<b>Graytone and B/W Speed at 400 dpi turbo</b>	4.0 "/sec	4.0 "/sec
<b>Scan Accuracy</b>	0.1% +- 1pixel	0.1% +-1 pixel
<b>Interface</b>	FireWire + Hi-Speed USB	FireWire + Hi-Speed USB

## Select SP25 BASE monochrome and Select SP25 PLUS Color Scanners

The Select SP25 BASE scanner is upgradable from monochrome-only to the Select SP25 PLUS monochrome and color. These 25" scanners are designed to introduce professionals to monochrome wide format document scanning at a highly affordable price while maintaining the option for color. These compact 25" scanners will fit in any office and are perfect devices for creating in-house graphics and impressive presentations right off the desktop. This scanner is the right investment for Graphics and designer firms, Sign Companies, Pre-press shops, Photo Labs, Copy shops, POP/Exhibit/Display Providers, Architect and Engineer offices.



	Select SP25 BASE	Select SP25 PLUS
<b>Scan Width</b>	25"	25"
<b>Optical Resolution</b>	424 dpi	424 dpi
<b>Max Resolution</b>	800 dpi	9600 dpi
<b>Color Speed at 400 dpi turbo</b>	-	0.3 "/sec
<b>Index Speed at 400 dpi turbo</b>	-	0.8 "/sec
<b>Graytone and B/W Speed at 400 dpi turbo</b>	4.0 "/sec	4.0 "/sec
<b>Scan Accuracy</b>	0.1% +- 1pixel	0.1% +-1 pixel
<b>Interface</b>	FireWire + Hi-Speed USB	FireWire + Hi-Speed USB

## 2. The Copy Scanners

### 2.1 About the Titan H36 and Designer 18 Scanners

Integrated copy/scan functionality (iJET technology) and LAN interfacing make these scanners unique and powerful players on the market for wide format copy/scan solutions. Users will get a device that can be setup as a stand-alone copier, a shared network scanner, a copy input source for any network printer or a combination of all.

The 18" A2 scanner model fulfills the market's demand for easy-to-use and document friendly flatbed scanners for wide formats. With flatbed scanners, you can digitize materials and three-dimensional objects *other* than paper, such as a piece of fabric, a picture mounted in a frame or a TV remote control. Basically, if you've ever made copies of something on a copy machine, you can scan it with a flatbed. Flatbed scanners mean users don't have to worry about material that is too stiff (such as your passport) or too small (such as your passport) or too fragile (such as your birth certificate). With a flatbed scanner, originals of almost any thickness can be scanned just as easy as scanning thin paper.

### 2.2 iJET Technology and iJET Panel

The Titan H36 and the Designer 18 scanners support hardware integrated copy/scan processing that enables users to perform advanced copy and scan-to-file jobs straight from the scanner **without PC or software to control and setup the scanner**. We call this "iJET Technology" and it is controlled through the iJET Panel on the scanner's topside. Activation of Scan-to-print from the iJET Panel will send the image directly to a local or network printer and with scan-to-file you can save the image data to a local or network PC that is setup to be recognized by the scanner.

The iJET Panel contains a small display window that provides users with an extended menu system for full control of copy and scan jobs. Additional control buttons allow quick setting of the most common copy parameters such as lightness, quality and scaling.

From the panel, users can set input and output paper sizes, determine the copy type, set quality parameters, set up a network printer, select a network PC as a scan-to-file target, set scan to file parameters, calibrate the scanner and much more. After applying copy/scan parameters, a single push of a button will send the job to a local or network printer (Copy button) or a network PC (Scan button).

#### From the iJET Panel you can...

- Send a Copy (BW or Color) with a single touch.
- Send a Scan-to-file job with a single touch.
- Make quick settings for Copying – *reduce/enlarge, print quality, no. of copies and lighter/darker*.
- Make advanced copy settings through the *Menu* button.
- Apply scanner and printer setup options through the *Menu* button.
- Apply personal and local preferences through the *Menu* button.
- Select a scan-to-file target through the *Scan to* button.
- Make scan-to-file settings through the *Scan to* button
- Scan-to-file settings are saved for each scan target and recalled when a user again selects the target.
- Calibrate the scanner and create media profiles.
- The display window contains the current selections as you make them and useful messages from the scanner regarding maintenance and operation.

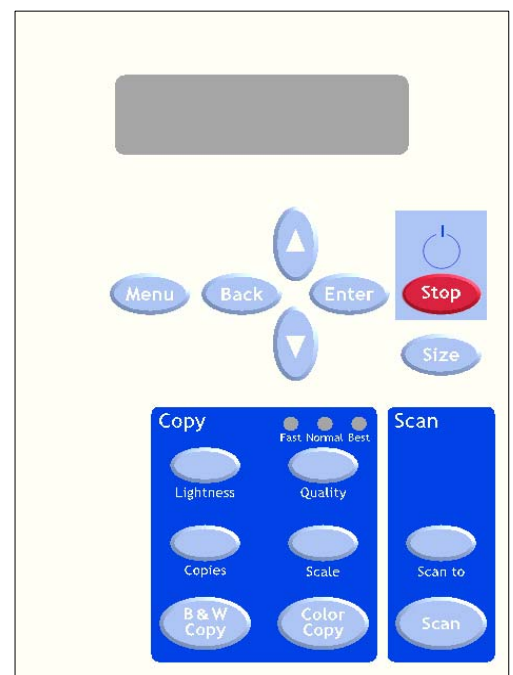

The iJET Panel – On the Designer 18

## New Copy Scanners

### 2.3 Connection and Configuration Solutions

Copy scanners can be used in different configuration solutions:

1. Stand Alone Copier Configuration.
2. Network Scan/Copy Device.
3. Scan/Copy Station on Local PC.
4. Combinations of the above for multiple functionalities.

#### Stand Alone Copier

Connect the scanner directly to a printer through the special USB host (output) port or LAN connection and thus create a large format copy solution with a scanner, printer and iJET Panel as your copy/scan operation controller. The scanner hardware contains its own processor, driver and memory so there is no need for a PC or scan/copy software with such a configuration. It is recommended to use USB interfacing with a printer wherever possible in order to keep the LAN port free and maintain the option for connecting the scanner to the network (see topic *Combined Configurations* below).

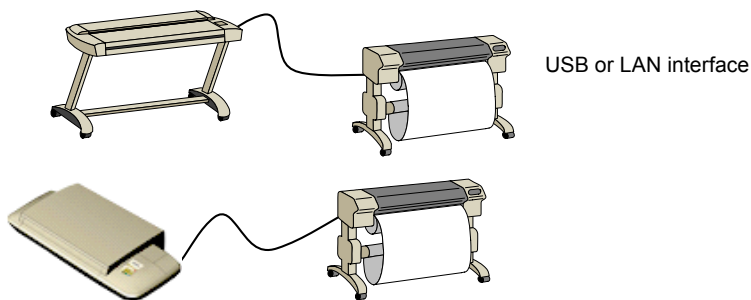

#### Network Scan/Copy Device

Connect the scanner directly to the LAN and enter it as a network device that can use and be used by other network resources.

When you connect the scanner to the network through the LAN port:

- You can send copy jobs to printers on the network using only the iJET Panel.
- You can send scan-to-file jobs to PCs on the network using only the iJET Panel (Designated Folder).
- Users can share the scanner – the scanner can be used with scan/copy software from PC workstations on the LAN.

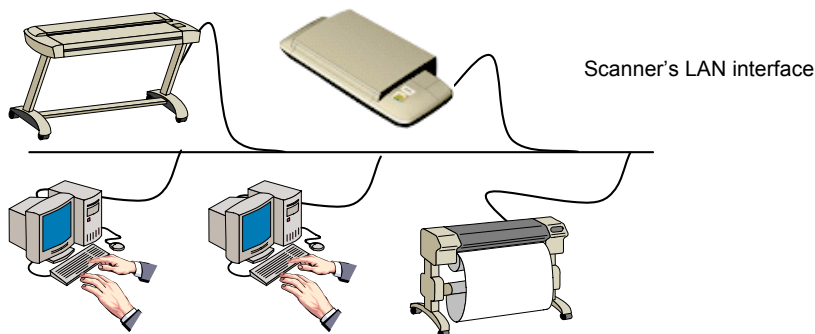

## Scan/Copy Station on Local PC

You can connect the scanner to a PC through Hi-Speed USB interfacing. This is the conventional scan/copy setup for controlling the scanner through scan/copy software on the PC. For copying, the configuration must be extended with a printer connected directly to the PC (local printer) or the PC can be connected to the network with access to network printers.

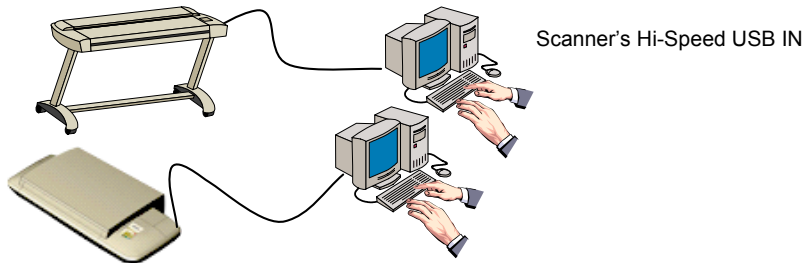

## Combined configurations

The three configurations: Stand alone copier, Scan/ Copy device on a network and Scan/ Copy station on local PC can be combined so they provide multiple functions. For most companies, a combined solution would be recommended to get the most out of the scanner device.

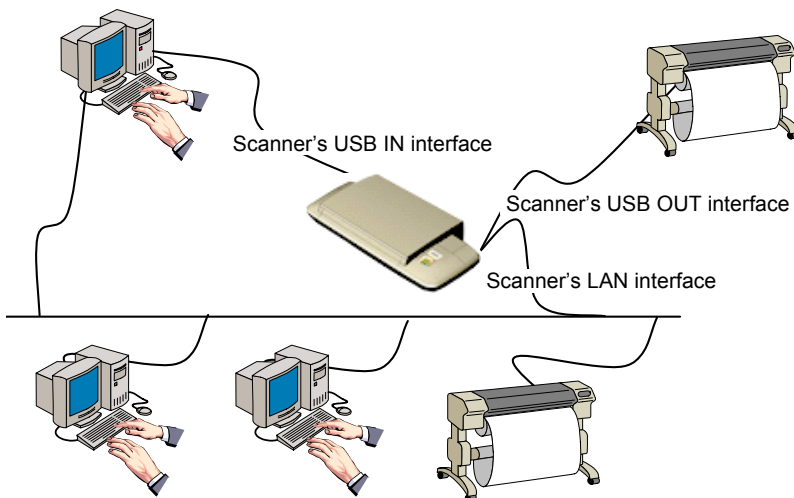

In the example illustrated above, we have connected both a printer and a PC directly to the scanner and both the scanner and the PC are separately attached to the network. This means that the configuration can be used as a stand alone copier, a stand alone scan-to-file station, a device for saving scans to network PCs and a shared device that can be controlled and used by network PCs. The scanner can use both the local printer and printers on the network. Both scan-to-file and copying can be performed either through the iJET Panel or through scan/copy software.

### 3. Key Features - Fulfilling User Needs

#### 3.1 General Product Features

##### 3.1.1 Upgradeable through the Smart Card

A Vidar scanner BASE model can be upgraded to its related PLUS model\*. After upgrading, users immediately gain the higher speeds and maximum resolutions of the high-end model. Upgrading from low-end to high-end models is facilitated through an Upgrade Kit that contains an upgrade smart card. Upgrade Kits are available from Vidar scanner dealers.

**\*NOTE:** Some scanners, such as the Designer 18 do not come in the two BASE/PLUS model versions and are not upgradeable.

Making the Vidar scanners upgradeable gives users the option to purchase a scanner on the low price end and if necessary, they can get features they may find they are missing at a later stage without suffering the heavy cost of a whole new scanner. With upgradeable scanners, smaller companies get a chance to enjoy wide format document scanning at a low budget risk while keeping options open.

##### 3.1.2 Easy installation – The WIDEsystem Tools CD

The WIDEsystem Tools CD-ROM is supplied with each new scanner. The CD contains all users need in order to get the scanner up and running plus the utilities for Scanner Maintenance.

**As a minimum, the WIDEsystem Tools CD-ROM will contain:**

- The scanner drivers (in WIDEsystem)
- Scanner Maintenance software
- Scanner Operators Guide

##### 3.1.3 Interfaces – FireWire, USB, SCSI and LAN

The table below shows the interface types supported on each scanner model.

Scanner Model	Interface Types
Designer 18	LAN + Hi-Speed USB + USB (Host-Printer)
Titan H36 BASE, PLUS	LAN + Hi-Speed USB + USB (Host-Printer)
Select SP25 BASE, PLUS	FireWire + Hi-Speed USB
Atlas SP25 BASE, PLUS	FireWire + Hi-Speed USB
Select MP36 BASE, PLUS	Firewire + SCSI
Nova MP36 BASE, PLUS	FireWire + Hi-Speed USB
Nova XP36 BASE, PLUS	FireWire + Hi-Speed USB
Select P36 BASE, PLUS	Firewire + SCSI
Atlas P36 BASE, PLUS	Firewire + SCSI
Select H42 BASE, PLUS	FireWire + Hi-Speed USB
Atlas H42 BASE, PLUS	FireWire + Hi-Speed USB
Atlas P54 BASE, PLUS	FireWire + SCSI

The Interface types and their characteristics are described below.

### About FireWire

FireWire can accommodate 400 megabits (around 50 megabytes) per second, which is more than adequate for high volume scanning of large formats. FireWire is a plug-and-play (PnP) specification. FireWire usage requires a FireWire Card and Port installed on the computer. FireWire support is rapidly becoming a standard installation on new PC's.

### About USB

USB is a connectivity specification that allows computer peripherals to be attached to a computer and eliminates the need to open the computer and install cards into dedicated slots. USB is a plug-n-play (PnP) specification that does not require configuration of switches or jumpers as with SCSI. USB, is supported on Windows 2000 and Windows XP and later versions. USB has become a standard and PC's and laptops come equipped with a USB port.

The Hi-Speed USB supports a data transfer speed of 480 megabits making it one of the industry's most effective interface options. Older computers with slower USB ports will function with the Hi-Speed USB (scanner) device but at slower speeds.

The iJET copy scanners – DESIGNER 18 and TITAN H36 have also a USB (full speed) output port for direct connection between scanner and printer.

### About SCSI

Setting up the SCSI connection requires installation of an SCSI board in your PC, installing the SCSI driver and setting the scanners SCSI connection ports. SCSI is recommended if you cannot use the FireWire connection option yet you require high speed color scanning. SCSI interface scanners support the Ultra SCSI (8-bit Narrow) SCSI type interface.

### About LAN

The LAN (Local Area Network) as a scanner interface means you can connect your scanner directly to a local network socket through an Ethernet cable. The scanner can then be used in combination with printers and/or PCs on the LAN, with operation of the scanner either from the scanner device itself or remotely from PCs on the network. Scanning to PCs will require that WIDEsystem installed on the PCs. Scanning from the PCs will additionally require compatible scan/copy software. Throughput speed depends on local network factors. You can also attach a printer with LAN support directly to the scanner (twisted LAN cable required) to configure a stand-alone copy machine.

## 3.1.4 Operating Systems

### Windows

Vidar scanners and software are continuously tested and developed to support the most current active Microsoft Windows version OS systems. Vidar scanners, interface and software support in relation to specific Windows versions will follow the Microsoft Support Lifecycle Policy.

The compatibility specifications listed below can therefore change accordingly.

The most current OS compatibility and support specifications will be updated and posted on [www.Vidar.com](http://www.Vidar.com)

See <http://support.microsoft.com/default.aspx?pr=lifecycle> for current information on Windows systems support from Microsoft.

### Macintosh

The Vidar WIDEcapture scanning plug-in for Adobe Photoshop, enables users to run Vidar scanners in a Macintosh environment. The latest version of WIDEcapture™ for Photoshop can be downloaded from [www.vidar.com](http://www.vidar.com) download area.

The Vidar Scanner Maintenance program including color and basic calibration is available for Macintosh users. The latest version of Scanner Maintenance for Macintosh can be downloaded from the [www.vidar.com](http://www.vidar.com) download area.

The most current OS compatibility and support specifications in relation to Macintosh OS versions will be posted on [www.vidar.com](http://www.vidar.com)

The table below shows each scanner's OS compatibility factors.

Scanner Model	Operating systems
Atlas P54 BASE, PLUS	Windows 2000, XP with SCSI Windows 2000, XP with FireWire Power Macintosh 10.2.8, 10.3 with FireWire
Atlas H42 BASE, PLUS	Windows 2000, XP with Hi-Speed USB Windows 2000, XP with FireWire Power Macintosh 10.2.8, 10.3 with FireWire
Select H42 BASE, PLUS	Windows 2000, XP with Hi-Speed USB Windows 2000, XP with FireWire Power Macintosh 10.2.8, 10.3 with FireWire
Titan H36 BASE, PLUS	LAN interfacing – no OS requirements for scanner. Network PCs accessing the scanner must fulfill the scan/copy/driver software's OS compatibility requirements. Connection to PC - Windows 2000, XP with Hi-Speed USB
Designer 18	LAN interfacing – no OS requirements for scanner. Network PCs accessing the scanner must fulfill the scan/copy/driver software's OS compatibility requirements. Connection to PC - Windows 2000, XP with Hi-Speed USB
Atlas P36 BASE, PLUS	Windows 2000, XP with SCSI Windows 2000, XP with FireWire Power Macintosh 10.2.8, 10.3 with FireWire
Select P36 BASE, PLUS	Windows 2000, XP with SCSI Windows 2000, XP with FireWire Power Macintosh 10.2.8, 10.3 with FireWire
Select MP36 BASE, PLUS	Windows 2000, XP with SCSI Windows 2000, XP with FireWire Power Macintosh 10.2.8, 10.3 with FireWire
Nova XP36 BASE, PLUS	Windows 2000, XP with Hi-Speed USB Windows 2000, XP with FireWire Power Macintosh 10.2.8, 10.3 with FireWire
Nova MP36 BASE, PLUS	Windows 2000, XP with Hi-Speed USB Windows 2000, XP with FireWire Power Macintosh 10.2.8, 10.3 with FireWire
Atlas SP25 BASE, PLUS	Windows 2000, XP with Hi-Speed USB Windows 2000, XP with FireWire Power Macintosh 10.2.8, 10.3 with FireWire
Select SP25 BASE, PLUS	Windows 2000, XP with with Hi-Speed USB Windows 2000, XP with FireWire Power Macintosh 10.2.8, 10.3 with FireWire

### 3.1.5 STI (Still Image Interface)

Vidar scanners retain their position as reliable long-term investments with support for STI (Still Image Interface) ensuring problem-free compatibility with current and future versions of Windows operating systems.

### 3.1.6 WIA (Windows Image Acquisition)

Windows Image Acquisition (WIA) enables imaging software programs, to communicate with imaging devices such as digital cameras and scanners. WIA was developed by Microsoft to promote the integration of imaging devices into Microsoft operating systems.

Vidar has added WIA compatibility into its scanner driver software WIDEsystem. With WIDEsystem installed under a WIA supported operating system with a WIA supported imaging application, users can scan with a Vidar scanner without the need for other special scan or copy software. Users will be able to set a number of the most common scan options such as scan mode, dpi and lightness settings. WIA compatibility strengthens Vidar' position as the provider of the market's large format scanner standard.

WIA also enables TWAIN interfacing (see below)

**NOTE:** WIA is supported on Windows XP.

### 3.1.7 TWAIN

TWAIN is a universal public standard which links applications (scan/imaging software) and image acquisition devices such as scanners. Vidar provides a TWAIN driver enabling users to use their large format scanner with the wide range of popular imaging applications that support the TWAIN standard.

#### **TWAIN support through WIA – Windows XP**

On Windows XP, communication between the scanner and TWAIN supportive applications can take place through WIA (Windows Image Acquisition). When the scanner is contacted from the application, users will be able to set basic scan options such as scan mode, dpi and lightness settings. The TWAIN component is automatically installed with WIDESystem<sup>NET</sup>

## 3.2 Features for High Scanning Quality

### 3.2.1 Sensors

#### **Four-linear CCD's**

With the exception of the two 25" models, all Vidar scanners support four-linear CCD's, with three lines for standard RGB scanning and a special panchromatic line that ensures that no colors are lost when scanning monochrome. The Vidar Atlas SP25" and Select SP25" scanner models use a single tri-linear color CCD. The Titan H36 scanner is equipped with high optical resolution CCDs of 600 dpi.

#### **Extended capture**

With exception of the Atlas P54, all Vidar scanners capture colors at 48 bits for maximum color precision, passing the best 24 bits to the computer. Graytones are captured at 16 bits passing the best 8 to the computer. The Atlas P54 captures at 42 and 14 bits.

See this overview's *Specification Comparison Table* (last page) for referencing the number CCDs, the total CCD pixel count and the optical resolution for each scanner.

### 3.2.2 Scan modes

#### **All Color models support:**

24-bit color

8 bit indexed color

8 bit Feature Extraction

#### **All models support:**

8-bit graytone

Copy modes with grayshades

B/W Dual 2D-Adaptive mode

1 bit black-and-white

### 3.2.3 Digital Image Processing

Advanced digital image processing features in the scanner ensure high capture precision of details, small type in maps and drawings, as well as the clear and reliable capture of continuous subtle color changes. The following Digital Image Processing features are supported on all the Vidar wide format scanner models:

#### **2D Adaptive Thresholding**

The threshold adapts to darker or lighter areas in the original. This processing method is suitable for scanning all kinds of line drawings including difficult blueprints, brown transparencies (sepias), etc. A stained or faded original can be renewed, as good sections are retained and bad ones clarified.

### Dual 2D-Adaptive Gray Copy

A special B/W copy mode for creating clear and enhanced printed output from old and faded originals. The Dual 2D-Adaptive Gray copy mode sends 8-bit graytone data to the ink-jet printer for further processing. Optimal results are obtained by taking full advantage of the high resolutions supported on the ink-jet printer.

### Dual 2D-Adaptive Enhancement

Processing modes for monochrome scanning in which an original type's best built-in enhancement features are combined. The combinations are incorporated in special copy modes for normal drawings, sepias, blueprints and photos. Image processing is applied simultaneously but independently on the foreground and background aspects of the drawing. This is a highly effective enhancement feature for creating high quality printouts of old originals.

### ADL+ Error Diffusion Halftoning

The hardware-embedded Digital Image Processing (DIP) performs fast image enhancement in real time. With the unique Area Diffusion Logic processing - ADL+ Error Diffusion halftoning, Vidar scanners can scan and print even the most demanding B/W and graytone documents with subtle differences between shades of gray maintained in the printed copy.

### 2D -Sharpening and Softening/2D - Blur filter

Active for both color and monochrome scanning. 2D-Sharpener, 2D-Softener and 2D-Blur color filters can be activated and combined for enhancing image quality.

### Color feature extraction

For color scanning - Embedded on-the-fly color feature extraction provides fast and easy classification and reduction of scanned colors to match those containing information in the scanned original.

### Color Adjustment

For color scanning - Users have full control over color parameters including independent RGB tone curves (Gamma), independent black-and-white point setting, 3x3 matrix multiplier, contrast, brightness, and tonal adjustment.

### 3.2.4 Accuracy Lens Enhancement Technology (ALE)

The ALE technology enhancement is one of Vidar' many patents used to develop world-class scanners that meet the harsh demands for accuracy in the GIS community and in other specialized vertical markets involved in Quality Assurance and Verification.

Accuracy Lens Enhancement (ALE) is an electronic correction of spherical errors in CCD based camera-scanning systems. Pixels across the image range of a camera can be more elliptical at the outer edges of the lens and more round in the middle of the lens. This anomaly is known as a spherical lens error. Most scanner manufactures typically state a  $\pm 0.1\%$  accuracy of the scanner between two end-points of the scan line. However, when measuring between two points that do not fall across the entire scan line it is not unusual to see variation much higher than  $\pm 0.1\%$ .

This is not acceptable in an environment that requires precision in its scanned images. For example, GIS professionals will require stability in the scanned image with a well-defined maximum error of 0.1% or less. Vidar has developed the process to electronically correct spherical errors and maintain a stable maximum error of less than  $0.1\% \pm 1$  pixel across **any two points** in the scan line.

### 3.3 Maintenance Tools for Continuous Problem-free Scanning

Scanner maintenance uses the **3C Auto-Maintenance System**, which is basically an automatic process as described in the next three sections.

#### 3.3.1 The importance of Scanner Maintenance

Regular scanner maintenance ensures your scanner and its cameras always deliver optimal image quality. The three routine maintenance procedures **cleaning**, **camera alignment** and **calibration** are closely entwined and they should all be performed in a single maintenance session, starting with cleaning the scan area and ending with calibration. The reason for this is simple. If you clean the glass or adjust the cameras then you will have changed conditions in the scanning area and will need to calibrate in order to readjust black and white. This works the other way as well – scanner calibration must always be preceded by cleaning and camera alignment to get reliable calibration results.

Because of the importance of scanner maintenance, Vidar scanners are designed with easy to use maintenance procedures implemented in the scanner system. Camera alignment and calibration is an automatic process in which the scanner adjusts itself. The maintenance tools include a single maintenance sheet for inserting in the scanner and a special cleaning cloth. The WIDEsystem Tools CD-ROM that comes with every scanner, contains software with wizard directed routines that check the scanner and guides users through the steps for perfect scanner camera alignment, stitching and calibration.

#### 3.3.2 Fully Automatic Camera Alignment – Built into the Scanner

Wide format scanners can use up to 4 cameras to capture the full wide format scan width. The cameras will periodically need to be realigned to always ensure perfect seams along camera range borderlines. On competitor scanners, this is a manual process performed by technicians.

On Vidar scanners, Camera Alignment is fully automatic. Users only need to insert the single pass Scanner Maintenance sheet, activate the process through the maintenance wizard and let the rest take care of itself. The Scanner Maintenance software and the scanner hardware work together to evaluate camera alignment on your scanner and make the corrections necessary for perfect alignment (height and stitching) on your cameras. Camera alignment correction is performed to a fraction of a pixel giving the market's highest wide format image precision.

#### 3.3.3 Fully Automatic Camera Calibration

After Camera alignment, the program continues on its own to Basic (black and white point) and Color Calibration. The Maintenance program detects the scanner model and makes all the necessary calculations. Easy and fast scanner calibration means that your scanner never suffers degradation, as is the case with other scanner devices with complicated or missing calibration support. The scanner's Precision Color system lets you calibrate on the field at any time ensuring stable and predictable color output. Vidar scanners are calibrated to both sRGB and NTSC color spaces using an ANSI IT8 calibration target.

#### 3.3.4 Auto Monitoring and Correction

Once the scanner has been fine-tuned, it performs a number of basic tasks on its own, removing those tedious chores required with other scanner systems. Using patented Vidar technology, camera stitching and black-white-points are constantly monitored and corrected while your scanner is running. Vidar scanners are designed to let you concentrate on your work and take optimal scanner performance for granted.

#### 3.3.5 Fast and Easy Replacement of Vital Scanner parts

Users can perform quick and easy replacement of vital scanner parts. After long-term use, renewing parts such as the glass plate, lamp, filters and white background will refresh the scanner and ensure optimal scanning results. Replacement of vital parts is a tool-free process.

Your scanner's driver monitors the life-length of vital parts and your system will output a message when it's time to consider a replacement.

Part-replacement was once an expensive technician-only task but now users can save time and money on technical service and keep their business up and running without costly delays. The scanner's open design lets users protect their investment by protecting their scanner from degradation.

The scanner models supporting replaceable parts are shown in the table below. Replaceable parts can be ordered through scanner distributors.

Scanner Model	Glass-Plate	Color-matched fluorescent lamps	White Background	Dust Filters
Atlas P54 BASE, PLUS	✓	-	-	-
Atlas H42 BASE, PLUS	✓	✓	✓	✓
Select H42 BASE, PLUS	✓	✓	✓	✓
Titan H36 BASE, PLUS	✓	✓	✓	✓
Designer 18	-	✓	✓	✓
Atlas P36 BASE, PLUS	-	-	-	-
Select P36 BASE, PLUS	-	-	-	-
Select MP36 BASE, PLUS	-	-	-	-
Nova XP36 BASE, PLUS	✓	✓	✓	-
Nova MP36 BASE, PLUS	✓	✓	✓	-
Atlas SP25 BASE, PLUS	-	-	-	-
Select SP25 BASE, PLUS	-	-	-	-

### 3.3.6 Scanner Validation

The Scanner Validation wizard is a new option accessible through the Scanner Maintenance wizard interface. You can use the Scanner Validation wizard to control that the scan area and calibration sheet are adequately clean before starting the calibration process. The validation wizard can also be run to troubleshoot unsatisfactory results or reported errors after running Scanner Maintenance.

On scanners with advanced diagnostics reporting (see below), the Scanner Validation program will report, through on-screen messages, the need to change replaceable key scanner parts such the glass plate, white background platen, air filters and lamp.

There are two main validation steps:

#### 1. Check if the scan area is clean

Correct scanner calibration (and operation) requires that your scan area is adequately clean. Before calibrating, users are always asked to clean the scanner glass-plate, white-background-platen and insertion area (the top flat surface in front of the insertion slot).

After cleaning, the Scan Area validation can determine if the scan area is adequately clean and if not, the wizard will point out critical areas that require additional cleaning.

#### 2. Check the Calibration Sheet's quality

A Scanner Maintenance calibration sheet is supplied with every scanner. The calibration sheet contains an IT8 color chart and camera alignment markings. The quality of calibration sheets can degrade over time with new being sheets obtainable through the scanner's dealer.

The Calibration Sheet validation function will determine if the current calibration sheet should be replaced with a fresh one for ensuring optimal scanner calibration and scan results.

### 3.3.7 Advanced Diagnostics Reporting

The following scanners contain a range of special sensors for advanced diagnostics control giving users even more accurate information on scanner trouble-shooting. Among other important items, these scanners will immediately report lamp failure, lamp sensor failure and fan failure.

*Scanners with Advanced Diagnostics Reporting:* Select H42 and Atlas H42.

### 3.4 Special User Features

#### 3.4.1 Advanced Power Management

Running with the right internal temperature is of utmost importance when doing high quality scanning through sensitive CCDs. Vidar scanners support **Advanced Power Management** that rapidly brings the scanner to its optimal working temperature, after which the temperature is monitored and held at a minimum level ensuring low CCD noise. The Advanced Power Management system contains advanced features with control through WIDESystem. Users can leave the scanner in low-power mode and program it to power up automatically at specific (clock) times before arriving at work so the scanner is ready to scan right away. The scanner's low-power mode now meets ENERGY STAR<sup>®</sup> criteria (see next section).

#### 3.4.2 ENERGY STAR<sup>®</sup>



office device.

ENERGY STAR is a program helping businesses and individuals protect the environment through superior energy efficiency. ENERGY STAR qualified scanners automatically enter a low-power "sleep" mode after a period of inactivity. Spending a large portion of time in low-power mode not only saves energy but helps scanner equipment run cooler and last longer. Many countries, markets and businesses look for ENERGY STAR compliant brands when investing in their next

Vidar scanner's automatic power down function now supports low power values that meet the strict ENERGY STAR criteria. In addition to the standard Timer clock setting feature already supported, power down can now be set in WIDESystem as an idle time period value. ENERGY STAR is supported on the new H scanners - the Atlas H42 and Select H42. The power down mode can be triggered manually from the panel, through WIDESystem's timer or through the idle time setting. Regardless of the triggering method, the power down mode in these scanners meets the strictly low power ENERGY STAR criteria.

#### 3.4.3 One Touch Scanning – Scan, Copy, E-mail



Vidar scanners\* incorporate an operator's panel with convenient action buttons. Each button immediately activates a scan and opens the scanned image in an appropriate application as described below:

**NOTE\*:** These buttons are not found on the copy scanners - Designer 18 and Titan H36. The copy scanners support one-touch-scanning through the advanced iJET panel with its direct copy/scan functionality.

##### Email Application



This button can activate WIDEmail™, a convenient application for sending scanned images via E-mail. When you press the Email Application button, you trigger a scan of the document currently loaded in the scanner and the result is then compressed into a JPEG file for effective transmission. On your PC, a window pops up with an email item and your scanned image attached. You just fill in the email address and click the send button.

##### Scan Application



This button can activate a scanning application if it is installed on your PC. When you press the Scan Application button, you trigger a scan of the document currently loaded in the scanner.

##### Copy Application



This button can activate a copy application if it is installed on your PC.

The action button behavior is set up per default upon installation of the WIDESystem scanner driver. The action buttons can be reprogrammed to carry out other functions. This procedure is described in the WIDESystem documentation that is included with the program.

### 3.4.4 Document feeding mechanism - Care for your original

The Vidar feeding systems are designed to ensure the highest standards for scanners that care for your original and for your scan results.

All-Wheel-Drive technology with precision rollers ensures a perfectly straight scanning path without using unnecessary force so you avoid both image distortion and damage to your customer's fragile originals. The axels are designed with synchronized roller movement to ensure a straight and stable scan path. Broad soft rollers ensure a firm grip on even very large originals.

The feeding systems on the SP, P and H scanners use dual shared axels and contour adjustment so both paper thin and thick, stiff originals feed smoothly on a straight path. Suspension components apply pressure evenly across the whole width of the document for an optimal yet gentle hold.

On the Nova MP and XP scanners, gentle-feed control lets you protect very fragile documents. Just raise the lid and watch the rollers lift, opening the drive pinch. Position your fragile document, close the lid, and now the document is safely engaged in the drive system.

The Designer 18 flatbed scanner does not involve an insertion slot or rollers that grip and move the original pass the cameras. With flatbed loading, the document remains static while the camera does the moving. This makes the Designer 18 flatbed the optimal scanner for very old and fragile originals.

### 3.4.5 Thick originals

With Vidar scanners, users do not have to limit themselves to working with paper-thin and flexible originals. In many cases, graphics and drawings are mounted on stiff and thick media that cannot be inserted into normal devices. With Vidar scanners, users can extend their scanning possibilities to include posters and maps mounted on foamboards, gatorboards and other stiff/thick media.

The Nova MP and XP scanner models have an adjustable insertion slot for scanning thick originals and can scan documents of up to 0.47-inch (12mm.) thick. The 25" scanner models also have a manually adjustable insertion slot and can scan documents of up to 0.6-inch (15mm.) thick.

The Atlas P54 and the H scanners support ATAC (Automatic Thickness Adjustment Control) that lets you use an operator panel button to raise and then sink the guide plate that automatically stops at the optimal height position and grip on the media. Sensors inside the scanner detect when the rollers are applying the right pressure and automatically stop the plate at that point. With ATAC technology, you are always ensured a perfect and even grip on any kind of original placed in the scanner. The ATAC models can scan documents of up to 0.6-inch (15mm.) thick.

On the Designer 18 flatbed scanner, you can scan originals up to 1,5" (38) mm thick with the lid closed. There are no limitations on thickness with the flatbed scanner if you scan with the lid open.

### 3.4.6 Versatile scanner through software support

Vidar scanners are compatible with the market's best software packages. A very wide variety of third party software applications will run with Vidar scanners and take advantage of the advanced built-in processing features. Some of the world's finest CAD, GIS, Archive and RIP applications are used with Vidar Scanners all over the world. See the Vidar website third party software area at <http://www.Vidar.com/thirdpartysw/> for information on specific applications. Vidar scanners are also compatible with many third party software applications through TWAIN and WIA as described earlier in this technical overview.

Vidar also makes its own software applications and for many users, these applications represent perfect solutions. For example, JETimage™ still astounds the market with extremely good color results through a very simple and straightforward interface. Here is a list of the Vidar applications. Detailed descriptions of the programs follow in this overview.

- **WIDecapture™ for Photoshop** – Scanning plug-in that works with Photoshop on WINDOWS and Macintosh Operating systems. Scans large format images directly into the Photoshop user interface.
- **WIDEmail** – This is a convenient application for sending large format scanned images via E-mail. The program can be activated from the scanner panel or from the computer screen. With WIDEmail you trigger a scan of the document currently loaded in the scanner and the result is then compressed into a JPEG file for effective email transmission. A window pops up with an email item and your scanned image attached.
- **Scanner Maintenance** – A software tool designed to make scanner maintenance an easy and automatic process. Quality scans and copies are only created on a clean and calibrated scanner. Regular maintenance should be a habit and the Scanner Maintenance software is supplied with every new scanner to help it become one.
- **WIDesystem<sup>NET</sup>** – A program designed to integrate the wide format scanner with the overall system. It contains the actual drivers that bring the scanner together with Windows. In addition, WIDesystem<sup>NET</sup> contains a scanner control interface that lets users monitor functions on the wide format-scanning device directly from the Windows interface system tray. WIDesystem<sup>NET</sup> sets up and controls scan to net features and enables communication through WIA and TWAIN (see next bullet)
- **WIA and TWAIN application support**– Vidar scanners can be run through WIA and TWAIN supported applications. This means that users, who mainly need to run simple scanning tasks with only the basic option settings, can choose not to purchase and install special scan/copy software. WIA and TWAIN for Vidar scanners are supported on Windows XP.



### 3.4.7 RoHS and WEEE Compliancy - Scanners for a Better Environment

Contex scanners continuously meet environmental restrictions and directives from all over the world.

The ROHS directive is “The restriction of the use of certain hazardous substances in electrical and electronic equipment”. The directive lists certain substances that must either be removed, or limited, in any products containing electrical or electronic components.

The Waste Electrical and Electronics Equipment (WEEE) directive was created to reduce environmental problems related to waste by setting collection, recycling and recovery targets for all types of electrical goods.

The RoHS and WEEE directives currently apply for all electrical and electronic products manufactured or sold in the European market and the rest of the world is expected to follow suite in the near future.

The new 42-inch scanners, the Atlas H42 and the Select H42 are RoHS/WEEE compliant. RoHS and WEEE compliancy will be incorporated in all future models.

## 4. Specification Comparison Table – WIDE Format Scanners

	Color/ Mono Scanning	Max Resolution	Optical Resolution	Speed 400dpi Turbo			CCD(s)	CCD Pixels	Interface Options	Max Media Width	Max Scan Width	Replaceable parts	ATAC	iJETPanel
				Color	Index	Graytone and B/W								
<b>18"</b>														
Designer 18	Color+mono	9600	400	3.0	3.0	10.0"/s	1	7500	LAN USB	Glass Area: 19.7" x 26.7" (501 x 678 mm)	18" (457mm)	√	-	√
<b>25"</b>														
Select SP25 BASE	mono	800	424	-	-	4.0"/s	1	10680	USB FireWire	28" (711mm)	25" (635mm)	-	-	-
Select SP25 PLUS	Color+mono	9600	424	0.3"/s	0.8"/s	4.0"/s	1	10680	USB FireWire	28" (711mm)	25" (635mm)	-	-	-
Atlas SP25 BASE	Color+mono	800	424	0.5"/s	1.5"/s	4.0"/s	1	10680	USB FireWire	28" (711mm)	25" (635mm)	-	-	-
Atlas SP25 PLUS	Color+mono	9600	424	1.5"/s	1.5"/s	4.0"/s	1	10680	USB FireWire	28" (711mm)	25" (635mm)	-	-	-
<b>36"</b>														
Select MP36 BASE	Mono	600	400	-	-	4.0"/s	2	15000	SCSI FireWire	43" (1092mm)	36" (914mm)	-	-	-
Select MP36 PLUS	Mono	9600	400	-	-	8.0"/s	2	15000	SCSI FireWire	43" (1092mm)	36" (914mm)	-	-	-
Select P36 BASE	Color+mono	800	400	0.3"/s	1.5"/s	3.0"/s	2	15000	SCSI FireWire	43" (1092mm)	36" (914mm)	-	-	-
Select P36 PLUS	Color+mono	9600	400	0.3"/s	1.5"/s	6.0"/s	2	15000	SCSI FireWire	43" (1092mm)	36" (914mm)	-	-	-
Atlas P36 BASE	Color+mono	800	400	1.5"/s	3.0"/s	3.0"/s	2	15000	SCSI FireWire	43" (1092mm)	36" (914mm)	-	-	-
Atlas P36 PLUS	Color+mono	9600	400	3.0"/s	3.0"/s	6.0"/s	2	15000	SCSI FireWire	43" (1092mm)	36" (914mm)	-	-	-
Nova MP36 BASE	Mono	9600	200	-	-	10.0"/s	1	7500	USB FireWire	44" (1118mm)	36" (914mm)	√	-	-
Nova MP36 PLUS	Color+mono	9600	200	0.3"/s	1.5"/s	10.0"/s	1	7500	USB FireWire	44" (1118mm)	36" (914mm)	√	-	-
Nova XP36 BASE	Color+mono	800	200	0.3"/s	1.5"/s	10.0"/s	1	7500	USB FireWire	44" (1118mm)	36" (914mm)	√	-	-
Nova XP36 PLUS	Color+mono	9600	200	3.0"/s	3.0"/s	10.0"/s	1	7500	USB FireWire	44" (1118mm)	36" (914mm)	√	-	-
Titan H36 BASE	Color+mono	800	600	1.5"/s	3.0"/s	6.0"/s	3	22500	LAN USB	44" (1118mm)	36" (914mm)	√	√	√
Titan H36 PLUS	Color+mono	9600	600	3.0"/s	3.0"/s	12.0"/s	3	22500	LAN USB	44" (1118mm)	36" (914mm)	√	√	√
<b>42"</b>														
Atlas H42 BASE	Color+mono	800	508	1.5"/s	3.0"/s	6.0"/s	3	22500	USB FireWire	44" (1118mm)	42" (1067mm)	√	√	-
Atlas H42 PLUS	Color+mono	9600	508	3.0"/s	3.0"/s	12.0"/s	3	22500	USB FireWire	44" (1118mm)	42" (1067mm)	√	√	-
Select H42 BASE	Color+mono	800	508	0.6"/s	3.0"/s	5.0"/s	3	22500	USB FireWire	44" (1118mm)	42" (1067mm)	√	√	-
Select H42 PLUS	Color+mono	9600	508	0.6"/s	3.0"/s	10.0"/s	3	22500	USB FireWire	44" (1118mm)	42" (1067mm)	√	√	-
<b>54"</b>														
Atlas P54 BASE	Color+mono	800	508	1.5"/s	3.0"/s	4.0"/s	4	30000	FireWire SCSI20	56" (1420mm)	54" (1372mm)	√	√	-
Atlas P54 PLUS	Color+mono	9600	508	3.0"/s	3.0"/s	8.0"/s	4	30000	FireWire SCSI20	56" (1420mm)	54" (1372mm)	√	√	-